



# ECOLANIC<sup>®</sup>

FINISHED ACRYLIC MORTAR  
FRATASADO AND DROP FOR  
PROTECTION AND DECORATION  
OF FACADES

MAPLEXINE<sup>®</sup> GM8

Maplexine<sup>®</sup>  
GM8



DETAIL

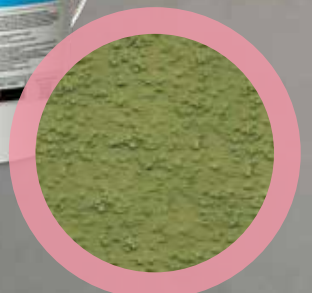

ACRYLIC MORTAR  
FRATASADO FINISH  
AND DROP FOR  
PROTECTION AND  
DECORATION OF  
FACADES

**MAPLEXINE®**  
**GM8**



## Description

Synthetic-mineral coating that comes in the form of a semi-solid paste that, once applied to the facing, transforms into a film of 2 mm thick quartz and silicon granules, perfectly adhered and with a high modulus of elasticity. It incorporates high hydrophobic properties that are complemented by a pleasant decorative appearance. It is manufactured in a wide range of referenced and à la carte standard color compositions.

Its innovative formulation, composed of nano additives and VOC-free resins, makes it a coating as effective as it is sustainable.

It is a plaster (totally free of cement, gypsum, plaster, lime and other hydraulic products), essentially made up of loads of quartz and silica granules bonded with synthetic resin and pigmented in the mass with stable pigments.

## Uses and fields of application

Maplexine® GM8 is used as a lining for any support or wall, facades, baseboards, stairwells, entrance halls, corridors, etc. It is a ready-to-use coating that comes in the form of a smooth thixotropic paste. Once applied, it creates a decorative coating with a frosted and drop finish, waterproof, highly resistant and beautiful, at the same time that it contributes, thanks to its selected loads, to covering the possible imperfections of the support. Also available in a Siloxane version.

It is used to coat and decorate facades or interior walls both in new construction and in renovation and AISLITE thermal insulation systems. (SATE). It adheres to all kinds of interior and exterior masonry surfaces such as brick facing, smooth formwork concrete faces, cement and sand plasters, concrete blocks, plaster plasters, reconstructed or agglomerated panels (wood fibers, etc.). ), wooden boards, fiber cement boards, metal panels (after an antioxidant treatment), etc ...

## Properties

### CHEMICALS:

- Insensitive to marine and corrosive atmospheres.
- Insensitive to dilute acid and alkaline solutions.
- Good washability with liquid detergents.
- Good resistance to aging.

ACRYLIC MORTAR  
FRATASADO FINISH  
AND DROP FOR  
PROTECTION AND  
DECORATION OF  
FACADES

**MAPLEXINE®**  
**GM8**



## Properties

### PHYSICAL:

- Waterproof to water, allowing the support to breathe.
- Great elasticity. It systematically clogs porosities and capillary microcracks.
- Good tensile strength.
- Very good resistance to shock and abrasion. (Rubbing wears the edge of a coin without damaging the coating.)
- Excellent adherence to all supports, not influencing the pH of the facing.
- Great stability against light.
- Good resistance to weathering.
- Perfect tightness.
- Non-flammable in a pasty state. Simple combustion without flame in dry state, at 250° C.
- Absolutely odorless once set.
- The applied film retains its properties at extreme temperatures of -30° C. and + 60° C.

## Special precautions

- Do not apply at temperatures below 5° C
- Do not apply on surfaces with horizontal exposure or inclinations below 60°
- Do not apply with relative humidity higher than 85%
- Do not apply on wet substrates (humidity less than 3%).
- Do not apply with risk of frost, strong winds or direct sun.
- Use gloves and protective glasses for use.
- Keep out of the reach of children.
- Supplies and tools will be cleaned with water immediately after use.
- Empty containers must be disposed of in accordance with current legislation.

## Consumption

Consumption is approximately  
2,5 - 3 kg / m<sup>2</sup> applied with a trowel.  
2 - 2.5 kg / m<sup>2</sup> applied with a spray gun

## Presentación

Supplied in 25kg plastic buckets. Packed on a 115x115cm pallet containing 36 units. 900kg



**Maplexine® GM8**

ACRYLIC MORTAR  
FRATASADO FINISH  
AND DROP FOR  
PROTECTION AND  
DECORATION OF  
FACADES

**MAPLEXINE®**  
**GM8**



**SP200 Print Base**



**Exploded tape on  
the facade**



## APPLICATION RULES

### Supports

It adheres to all kinds of interior and exterior masonry surfaces such as brick facing, smooth formwork concrete faces, cement and sand plasters, concrete blocks, plaster plasters, reconstructed or agglomerated panels (wood fibers, etc.), wooden boards, fiber cement boards, metal panels (after an antioxidant treatment), etc ...

### Preparation of the support

In applications on soft gypsum facing, the prior application of our AGMA - CH hardener product is necessary.

The surfaces must be scraped from the remains of previous paints and brushed to remove any type of impurity that may affect the adherence of MAPLEXINE® GM8. The surface material must be solid and dry.

For reasons of appearance, to avoid the risks of appearance after drying of joints by resuming work and to allow subsequent repairs that do not affect the general appearance of the application, it is necessary to divide the surface to be applied into zones by means of simulated joints. These joints must be treated in such a way that they cannot favor the passage of water between the cladding and the support. It is for this reason that the application of an anchoring primer is necessary (Print Base SP200, color to choose from the range).

These application areas should be of such a size that they allow the application of their entire surface without interruption.

The edges or upper limits of the surfaces treated with this cladding must be properly protected (cornices, eaves, etc.) so that rainwater does not penetrate between the cladding and the support and, in addition, does not drag on the facing. the dirt deposited on the horizontal surfaces of the upper parts.

### Product preparation

The supplied material is suitable for use with no more than a removal of the contents of the container, or a maximum addition of 2% of water, until correct homogeneity is achieved.

ACRYLIC MORTAR  
FRATASADO FINISH  
AND DROP FOR  
PROTECTION AND  
DECORATION OF  
FACADES

**MAPLEXINE®**  
**GM8**



**GM8 trowel application**



**GM8 projection**



## APPLICATION RULES

### Application

This mixture is spread on the facing, using a plastic or stainless steel trowel. The minimum consumption per square meter for a correct application is 2.5 to 3 kg / m<sup>2</sup>. It is necessary to take precautions in the continuation of the work after an intervention since, otherwise, there is a risk that the appearance of the set presents irregularities, particularly in applications on large surfaces.

The trowel application is normally carried out in three phases:

1. A layer of MAPLEXINE® SP200 Print Base of the same reference as the MAPLEXINE® GM8.
2. A layer of MAPLEXINE® coating GM8.
3. A troweling of the applied coating, done in time and form with a plastic trowel. The coating hardens after about 12 hours under normal conditions. Full hardening is reached after a period of approximately 3 weeks. The spray application is carried out as follows. Apply the final drop or zip line with a 4 or 6 mm nozzle. and a gun pressure of approximately 1.5 to 2.5 kg / cm<sup>2</sup>. A small proportion of water can be added depending on the type of equipment and nozzle to be used. For transporting the material, a boiler pressure of 3 to 5 kg / cm<sup>2</sup> is recommended depending on the length of the hose.

With the operations that are described, the product will offer the appearance of a conventional or zip-line gotelé, with the possibility of presenting a different finish as follows: Once the drip layer is finished, the time necessary for the dripping to dry superficially, but still somewhat soft in its mass, and then a plastic spatula is gently passed over the surface, which will obtain, when stepping on the drop, a finish with a pleasant decorative appearance.

Note: For applications, both interior and exterior, in which a glossy and softer touch finish is desired, we recommend the use of our CIDEX AC varnish (see technical data sheet).



ACRYLIC MORTAR  
FRATASADO FINISH  
AND DROP FOR  
PROTECTION AND  
DECORATION OF  
FACADES

**MAPLEXINE®**  
**GM8**

## SATE AISLITE System Application Phases

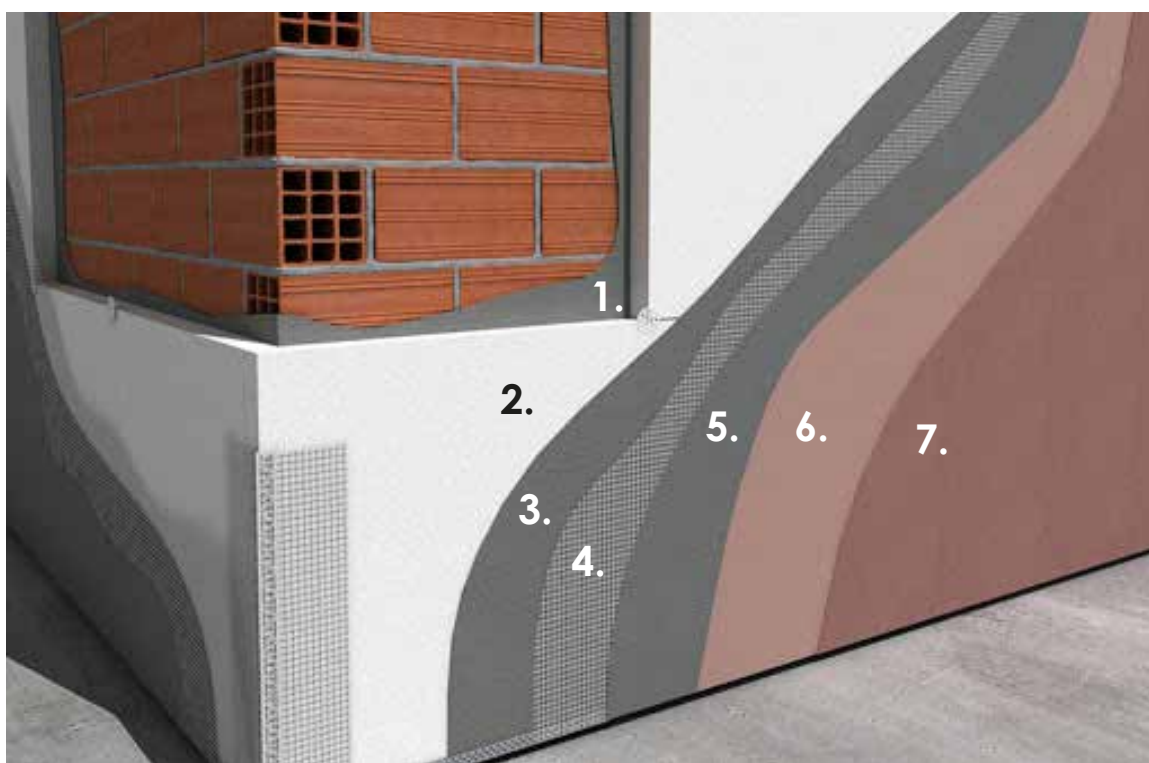

1. CEMENT FOAM AISLITE. GLUING OF PLATES
2. EPS. SPRAY POLYSTYRENE
3. CEMENT FOAM AISLITE EPS COVERAGE AND MESH GLUING
4. PAVINET (SATE). FIBERGLASS MESH
5. CEMENT FOAM AISLITE. MESH COVER LAYER
6. PRINTING BASE SP200. PRIMING THE SUPPORT
7. MAPLEXINE® GM8

ACRYLIC MORTAR  
FRATASADO FINISH  
AND DROP FOR  
PROTECTION AND  
DECORATION OF  
FACADES

**MAPLEXINE®**  
**GM8**



## TECHNICAL DATA characteristic values

### Product identification data

<b>Consistency:</b>	Thixotropic soft paste.
<b>Color</b>	White and color chart
<b>Pigments:</b>	Suitable according to color and with high resistance to the exterior, extenders and calcareous-siliceous loads.
<b>PH:</b>	7.5
<b>Density (g / cm<sup>3</sup>):</b>	1.8 84 ±
<b>Dry residue (%):</b>	2%

### Application data

<b>Dilution ratio:</b>	Ready to use. Shake to recover homogenization
<b>Approx. drying:</b>	12h
<b>Application temperature:</b>	+ 5 to + 30°C
<b>Finishes:</b>	Matte

### Benefits

**Maximum Performance:** After 21 days  
**Adherence:** Good ≥ 3 Mpa  
**Water vapor permeability:** V2  
**Water absorption coefficient** W3  
**VOC content in the ready-to-use product (European Directive 2004/42 / EC) (g / l):** ≤ 5



ACRYLIC MORTAR  
FRATASADO FINISH  
AND DROP FOR  
PROTECTION AND  
DECORATION OF  
FACADES

**MAPLEXINE®**  
**GM8**



**SAFETY AND HYGIENE INFORMATION**

It is not classified as dangerous according to current regulations on mixtures. For any information regarding safety issues in the use, handling, storage and disposal of chemical residues, users should consult the most recent version of the Product Safety Sheet. Empty containers must be disposed of in accordance with current legal regulations.

**STORAGE CONDITIONS**

The life time of the material is 12 months from the date of manufacture provided it is kept in a dry place and protected from the weather.

**NOTE:** The instructions for use are made according to our tests and knowledge and are not binding. They do not free the consumer from the examination and verification of the products for their correct use. The company's liability will be limited to the value of the merchandise used.

**Descriptive memory**

Application of acrylic mortar with a frosted finish or drop effect MAPLEXINE® GM8 color to be determined from Ecolanic or equivalent, flexible, ready to use, based on acrylic copolymers. Great hardness and extraordinary resistance to abrasion, as well as to atmospheric agents, with high hydrophobic resistance and high covering power. Coating composed of nano additives and VOC-free resins. Façade application on concrete support or mortar plaster with minimum resistance to compression CIII, previously prepared with anchoring primer BASE IMPRESIÓN SP200 from Ecolanic.

The product must comply with the following technical characteristics:

**Density (g / cm<sup>3</sup>):** 1.8

**Dry residue (%):** 84

**Application temperature:** + 5 a + 30°C

**Finishes:** Mate

**Maximum Performance:** After 21 days

**Adherence:** Good ≥ 3 Mpa

**Water vapor permeability:** V2

Water absorption: W3

**Reaction to fire:** A2-s1, d0

**VOC content in the ready-to-use product (European Directive 2004/42 / EC) (g / l):** ≤ 5