



ECOLANIC[®]

ROUGH STONE COATING FOR PROTECTION AND DECORATION OF FACADES

MAPLEXINE[®] GM6-R



Maplexine[®]
GM6-R



DETAIL



ROUGH STONE
COATING
FOR PROTECTION
AND DECORATION
OF FACADES

MAPLEXINE®
GM6-R



Description

Stone coating Rough, flexible, ready to use, based on acrylic copolymers with great hardness, high adhesion power and extraordinary resistance to abrasion, as well as to atmospheric agents, with high hydrophobic resistance and high covering power. Its innovative formulation, composed of nano additives and VOC-free resins, makes it a coating as effective as it is sustainable.

Uses and fields of application

GM6-R is a ready-to-use stone coating in the form of a smooth thixotropic paste. Uniform coarse-grained matte finish that, once applied, creates a monochromatic decorative support of high resistance and beauty. Its interesting technical characteristics are complemented by the possibility of choosing, to the user's liking, different surface aspects with a very pleasant decorative effect. time that contributes, thanks to its selected loads, to cover the possible imperfections of the support. Also available in GM6-R SIL Siloxane version.

GM6-R is used to clad and decorate facades or interior walls in both new construction and refurbishment (SATE). It adheres to all kinds of interior and exterior masonry surfaces such as brick facing, smooth formwork concrete faces, cement and sand plasters, concrete blocks, plaster plasters, reconstructed or agglomerated panels (wood fibers, etc.), wooden boards, fiber cement boards, metal panels (after an antioxidant treatment), etc ...



ROUGH STONE
COATING
FOR PROTECTION
AND DECORATION
OF FACADES

MAPLEXINE® GM6-R



Properties

CHEMICALS:

- Insensitive to marine and corrosive atmospheres.
- Good resistance to aging.
- Good washability with liquid, neutral or acidic detergents that do not contain bleaches. A sponge or soft brush.
- Good resistance against fungi and algae.
- Total setting 21 days after application.

PHYSICAL:

- Good resistance to water penetration, but allowing perspiration of the facing thanks to its adequate vapor permeability.
- High water resistance, easily visible visually.
- Good elasticity, which hinders the appearance of pores and microcracks.
- Good resistance to traction, impact and abrasion.
- Excellent adherence to the support over time.
- Great stability against sunlight.
- Good resistance to weathering.
- Non-flammable, once simple flameless combustion is applied at 250° C (482° F).
- Absolutely odorless once set.
- The applied product maintains all its properties in the temperature range of -36°C. (- 31°F) and + 60° C. (149°F).
- Repainted in 6-12 hours in summer and 24 hours in winter.

Special precautions

- Do not apply at temperatures below 5° C
- Do not apply with relative humidity higher than 85%
- Do not apply on wet substrates (humidity less than 3%).
- Do not apply with risk of frost, strong winds or direct sun.
- Use gloves and protective glasses for use.
- Keep out of the reach of children.
- Supplies and tools will be cleaned with water immediately after use.
- Empty containers must be disposed of in accordance with current legislation.

Consumption

Yield: from 1 to 2 m² / kg per coat depending on the support and texture made.

- Repainting: The second coat will be applied allowing to dry for 3 to 4 hours.

Presentation

Supplied in 25kg plastic buckets. Packed on a 115x115cm pallet containing 36 units. 900kg



Maplexine® GM6-R

ROUGH STONE
COATING
FOR PROTECTION
AND DECORATION
OF FACADES

MAPLEXINE® GM6-R



SP200 Print Base



**GM6-R Application
on SP200 Print Base**

APPLICATION RULES

Supports

It adheres to all kinds of interior and exterior masonry surfaces such as brick facing, smooth formwork concrete faces, cement and sand plasters, concrete blocks, plaster plasters, reconstructed or agglomerated panels (wood fibers, etc.), wooden boards, fiber cement boards, metal panels (after an antioxidant treatment), etc ...

Preparation of the support

In applications on soft gypsum facing, the prior application of our AGMA - CH hardener product is necessary.

The surfaces must be scraped from the remains of previous paints and brushed to remove any type of impurity that may affect the adherence of MAPLEXINE® GM6-R. The surface material must be solid and dry.

Highly absorbent surfaces must be previously treated with our MAPLEXINE IMPRESSION BASE®.

Also in applications made on very hot days to prevent the applied product from drying too quickly.

Product preparation

The material supplied is already formulated for direct use, with no more than a removal of the contents of the container or a maximum addition of 2% of water.

Application

Make a first test to fix the desired texture. The higher relief textures are achieved by adding more material to the facing; on the contrary, adding water to the material decreases the relief obtained.

Spread the material deposited on the roller on the facing, ensuring that the contribution is always the same. Once this extension has been carried out vertically, pass the roller, without loading it with material, horizontally to compact and equalize.

Another way to add material to the support is through a thick brush, which facilitates a layer of calibrated thickness.

ROUGH STONE
COATING
FOR PROTECTION
AND DECORATION
OF FACADES

MAPLEXINE® GM6-R



APPLICATION RULES

Application

From any of these alternatives, the final textures can be:

- ROLLER. One last pass always in the same direction (whichever is desired) so that the texture has a uniform appearance.
- A SPONGE, COMB, SPATULA, ETC ..., depending on the available tool, different aspects will be carried out.
- Dry to the touch: ½ to 1 hour, depending on the thickness.
- Repainting: A second coat can be given at 6 o'clock.

Finish

The Maplexine® GM6-R in the described way, gives a matte finish. If a glossy finish is desired, and to increase the protection requirements, the application of the CIDEX AC finishing varnish can be incorporated.

SATE AISLITE System Application Phases

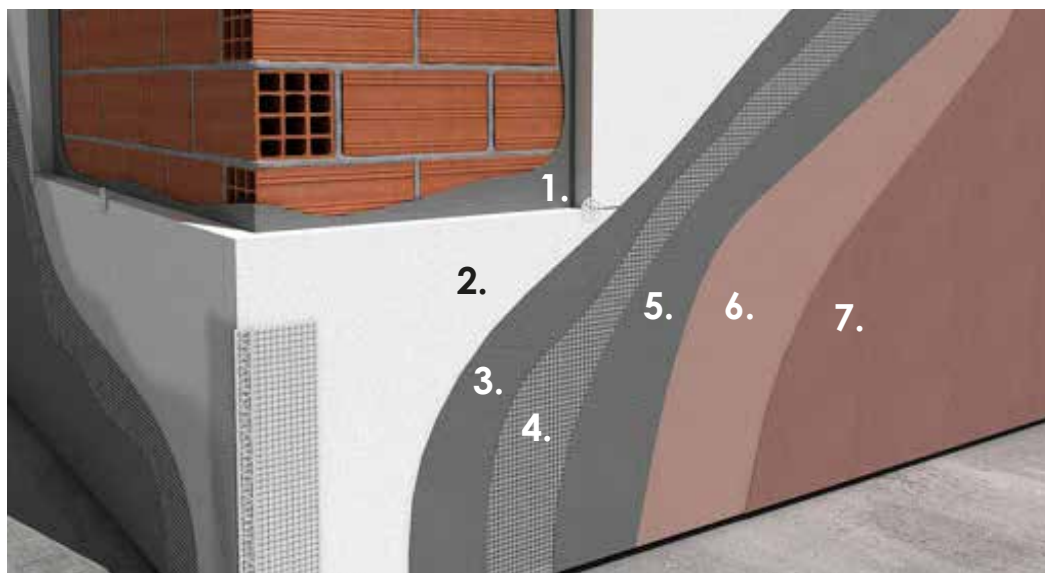

1. CEMENT FOAM AISLITE. GLUING OF PLATES
2. EPS. SPRAY POLYSTYRENE
3. CEMENT FOAM AISLITE EPS COVERAGE AND MESH GLUING

4. PAVINET (SATE). FIBERGLASS MESH
5. CEMENT FOAM AISLITE. MESH COVER LAYER
6. PRINTING BASE SP200. PRIMING THE SUPPORT
7. MAPLEXINE® GM6R

ROUGH STONE
COATING
FOR PROTECTION
AND DECORATION
OF FACADES

MAPLEXINE® GM6-R



TECHNICAL DATA characteristic values

Product identification data

Consistency:	Thixotropic soft paste.
Color	White and color chart
Pigments:	Suitable according to color and with high resistance to the exterior, extenders and calcareous-siliceous loads.
PH:	7.5
Density (g / cm³):	1.65
Dry residue (%):	74.65

Application data

Dilution ratio:	Ready to use. Shake to recover homogenization
Approx. drying:	30 minutes to the touch
Interval between layers:	6 hours approx. at 23°C and 50% relative humidity.
Application temperature:	+ 5 to + 30°C
Finishes:	Matte

Benefits

Maximum Performance: After 15 days
Adherence: Good
Water absorption coefficient (EN 1062-3) W2 ($\leq 0.1 \text{ Kg} / \text{m}^2$ H1 / 2)
VOC content in the ready-to-use product (European Directive 2004/42 / EC) (g / l): ≤ 5



ROUGH STONE
COATING
FOR PROTECTION
AND DECORATION
OF FACADES

MAPLEXINE®
GM6-R



SAFETY AND HYGIENE INFORMATION

It is not classified as dangerous according to current regulations on mixtures. For any information regarding safety issues in the use, handling, storage and disposal of chemical residues, users should consult the most recent version of the Product Safety Sheet. Empty containers must be disposed of in accordance with current legal regulations.

STORAGE CONDITIONS

The life time of the material is 12 months from the date of manufacture provided it is kept in a dry place and protected from the weather.

NOTE: The instructions for use are made according to our tests and knowledge and are not binding. They do not free the consumer from the examination and verification of the products for their correct use. The company's liability will be limited to the value of the merchandise used.

Descriptive memory

Two-coat application of smooth MAPLEXINE® stone coating GM6-R color to be determined from Ecolanic or equivalent, flexible, ready to use, based on acrylic copolymers. Great hardness and extraordinary resistance to abrasion, as well as to atmospheric agents, with high hydrophobic resistance and high covering power. Coating composed of nano additives and VOC-free resins. Façade application on concrete support or mortar plaster with minimal resistance to compression CIII, previously prepared with AGMA CH sealer or Ecolanic Impression Base.

The product must comply with the following technical characteristics:

Density (g / cm³): 1.65

Dry residue (%): 74.65

Application temperature: + 5 to + 30°C

Finishes: Matte

Maximum Performance: After 15 days

Adherence: Good

Water absorption coefficient (EN 1062-3) W₂ (≤ 0.1 Kg / m² · h¹ / 2)

VOC content in the ready-to-use product (European Directive 2004/42 / EC) (g / l): ≤ 5