



# ECOLANIC®

SMOOTH STONE COATING  
FOR PROTECTION  
AND DECORATION  
OF FACADES DETAIL

MAPLEXINE® GM6-L

Maplexine®  
GM6-L



DETAIL



SMOOTH STONE  
COATING  
FOR PROTECTION  
AND DECORATION  
OF FACADES DETAIL

**MAPLEXINE®  
GM6-L**



## Description

Smooth, flexible, ready-to-use stone coating based on acrylic copolymers with great hardness, high adhesion power and extraordinary resistance to abrasion, as well as to atmospheric agents, with high hydrophobic resistance and high covering power. Its innovative formulation, composed of nano additives and VOC-free resins, makes it a coating as effective as it is sustainable.

## Uses and fields of application

GM6-L is a ready-to-use stone coating in the form of a smooth thixotropic paste. Uniform fine grain matte finish that, once applied, creates a monochromatic decorative support of high resistance and beauty, at the same time that it contributes, thanks to its selected loads, to cover the possible imperfections of the support. Also available in GM6-L SIL Siloxane version.

GM6-L is used to clad and decorate facades or interior walls in both new construction and renovation (SATE). It adheres to all kinds of interior and exterior masonry surfaces such as brick facing, smooth formwork concrete faces, cement and sand plasters, concrete blocks, plaster plasters, reconstructed or agglomerated panels (wood fibers, etc.)., wooden boards, fiber cement boards, metal panels (after an antioxidant treatment), etc ...



Rehabilitation with GM6-L on Crepi



Facade with GM6-L

SMOOTH STONE  
COATING  
FOR PROTECTION  
AND DECORATION  
OF FACADES DETAIL

**MAPLEXINE®  
GM6-L**



## Properties

### CHEMICALS:

- Insensitive to marine and corrosive atmospheres.
- Good resistance to aging.
- Good washability with liquid, neutral or acidic detergents that do not contain bleaches. A sponge or soft brush.
- Good resistance against fungi and algae.
- Total setting 21 days after application.

### PHYSICAL:

- Good resistance to water penetration, but allowing perspiration of the facing thanks to its adequate vapor permeability.
- High water resistance, easily visible visually.
- Good elasticity, which hinders the appearance of pores and microcracks.
- Good resistance to traction, impact and abrasion.
- Excellent adherence to the support over time.
- Great stability against sunlight.
- Good resistance to weathering.
- Non-flammable, once simple flameless combustion is applied at 250° C (482° F).
- Absolutely odorless once set.
- The applied product maintains all its properties in the temperature range of -36°C. (- 31°F) and + 60° C. (149°F).
- Repainted in 6-12 hours in summer and 24 hours in winter.

## Special precautions

- Do not apply at temperatures below 5° C
- Do not apply with relative humidity higher than 85%
- Do not apply on wet substrates (humidity less than 3%).
- Do not apply with risk of frost, strong winds or direct sun.
- Use gloves and protective glasses for use.
- Keep out of the reach of children.
- Supplies and tools will be cleaned with water immediately after use.
- Empty containers must be disposed of in accordance with current legislation.

## Consumption

Yield: 5 to 7 m2 / kg per coat depending on the support.

## Presentation

Supplied in 25kg plastic buckets. Packed on a 115x115cm pallet containing 36 units. 900kg



**Maplexine® GM6-L**



SMOOTH STONE  
COATING  
FOR PROTECTION  
AND DECORATION  
OF FACADES DETAIL

**MAPLEXINE®  
GM6-L**



**SP200 Print Base**



**GM6-L application  
on SP 200 Print Base**



## APPLICATION RULES

### Supports

It adheres to all kinds of interior and exterior masonry surfaces such as brick facing, smooth formwork concrete faces, cement and sand plasters, concrete blocks, plaster plasters, reconstructed or agglomerated panels (wood fibers, etc.), wooden boards, fiber cement boards, metal panels (after an antioxidant treatment), etc ...

### Preparation of the support

In applications on soft gypsum facing, the prior application of our AGMA - CH hardener product is necessary.

The surfaces must be scraped from the remains of previous paints and brushed to remove any type of impurity that may affect the adherence of MAPLEXINE® GM6-L. The surface material must be solid and dry.

Highly absorbent surfaces must be previously treated with our MAPLEXINE IMPRESSION BASE. Also in applications made on very hot days to prevent the applied product from drying too quickly.

### Product preparation

Product normally ready for use but it is convenient to shake until it is perfectly homogenized.

### Application

- Dilute the first layer with approximately 15% water. On highly absorbent surfaces, a previous coat of preparation with the same product diluted 40-50% is very beneficial. Otherwise, apply our MAPLEXINE IMPRESSION BASE®.
- The second and following can be diluted up to a maximum of 5% with water
- It can be applied by brush or roller. The roller will provide better application and lower consumption. It can also be carried out by spray projection, without air, with an ambient temperature of not less than 5°C.
- Dry to the touch: ½ to 1 hour.
- Repainting: A second coat can be given at 6 o'clock.

SMOOTH STONE  
COATING  
FOR PROTECTION  
AND DECORATION  
OF FACADES DETAIL

**MAPLEXINE®**  
**GM6-L**

## APPLICATION RULES

### Finish

The Maplexine® GM6-L in the described way, gives a matte finish. If a glossy finish is desired, and to increase the protection requirements, the application of the CIDEX AC finishing varnish can be incorporated.

## SATE AISLITE System Application Phases

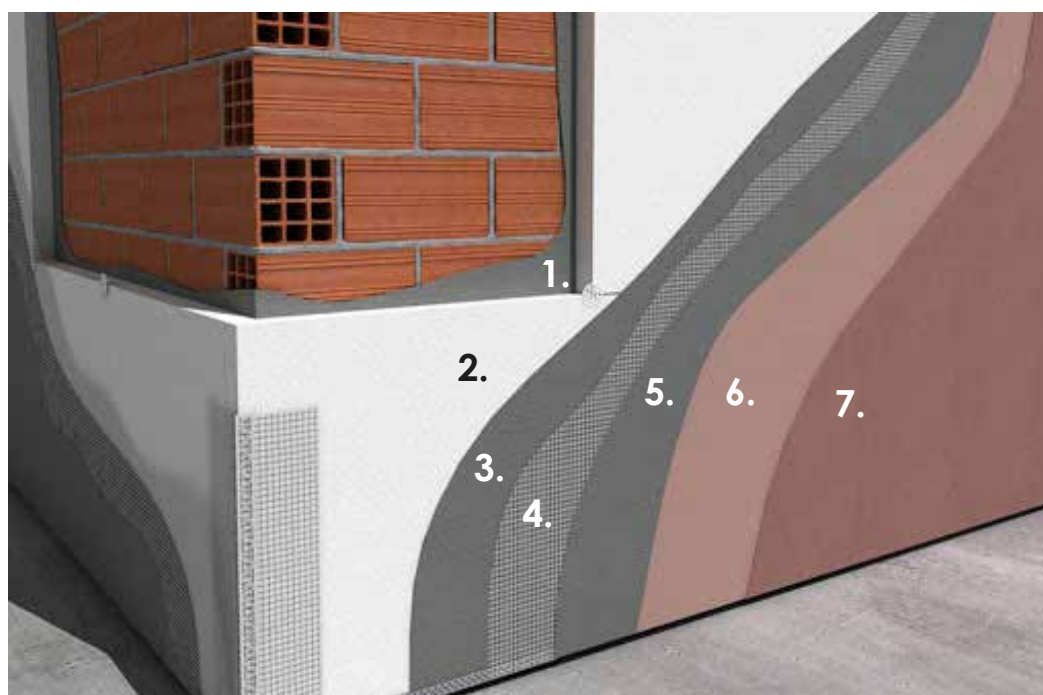

1. CEMENT FOAM AISLITE. GLUING OF PLATES
2. EPS. SPRAY POLYSTYRENE
3. CEMENT FOAM AISLITE EPS COVERAGE AND MESH GLUING

4. PAVINET (SATE). FIBERGLASS MESH
5. CEMENT FOAM AISLITE. MESH COVER LAYER
6. PRINTING BASE SP200. PRIMING THE SUPPORT
7. MAPLEXINE® GM6L

SMOOTH STONE  
COATING  
FOR PROTECTION  
AND DECORATION  
OF FACADES DETAIL

**MAPLEXINE®**  
**GM6-L**



## TECHNICAL DATA characteristic values

### Product identification data

<b>Consistency:</b>	Thixotropic soft paste.
<b>Color</b>	White and color chart
<b>Pigments:</b>	Suitable according to color and with high resistance to the exterior, extenders and calcareous-siliceous loads.
<b>PH:</b>	7.5
<b>Density (g / cm<sup>3</sup>):</b>	1.65
<b>Dry residue (%):</b>	74.65

### Application data

<b>Dilution ratio:</b>	Ready to use. Shake to recover homogenization
<b>Approx. drying:</b>	30 minutes to the touch
<b>Interval between layers:</b>	6 hours approx. at 23°C and 50% relative humidity.
<b>Application temperature:</b>	+ 5 to + 30°C
<b>Finishes:</b>	Matte

### Benefits

**Maximum Performance:** After 15 days

**Adherence:** Good

**Water absorption coefficient (EN 1062-3) W2** ( $\leq 0.1 \text{ Kg} / \text{m}^2$  H1 / 2)

**VOC content in the ready-to-use product (European Directive 2004/42 / EC) (g / l):**  $\leq 5$



SMOOTH STONE  
COATING  
FOR PROTECTION  
AND DECORATION  
OF FACADES DETAIL

**MAPLEXINE®**  
**GM6-L**



**SAFETY AND HYGIENE INFORMATION**

It is not classified as dangerous according to current regulations on mixtures. For any information regarding safety issues in the use, handling, storage and disposal of chemical residues, users should consult the most recent version of the Product Safety Sheet. Empty containers must be disposed of in accordance with current legal regulations.

**STORAGE CONDITIONS**

The life time of the material is 12 months from the date of manufacture provided it is kept in a dry place and protected from the weather.

**NOTE:** The instructions for use are made according to our tests and knowledge and are not binding. They do not free the consumer from the examination and verification of the products for their correct use. The company's liability will be limited to the value of the merchandise used.

**Memoria descriptiva**

Two-coat application of smooth MAPLEXINE® stone coating GM6-L color to be determined from Ecolanic or equivalent, flexible, ready to use, based on acrylic copolymers. Great hardness and extraordinary resistance to abrasion, as well as to atmospheric agents, with high hydrophobic resistance and high covering power. Coating composed of nano additives and VOC-free resins. Façade application on concrete support or mortar plaster with minimal resistance to compression CIII, previously prepared with AGMA CH sealer or Ecolanic Impression Base.

The product must comply with the following technical characteristics:

**Density (g / cm<sup>3</sup>):** 1.65

**Dry residue (%):** 74.65

**Application temperature:** + 5 to + 30°C

**Finishes:** Matte

**Maximum Performance:** After 15 days

**Adherence:** Good

**Water absorption coefficient (EN 1062-3) W<sub>2</sub> (≤ 0.1 Kg / m<sup>2</sup> · h<sup>1</sup> / 2)**

**VOC content in the ready-to-use product (European Directive 2004/42 / EC) (g / l):** ≤ 5

